



SAMURAI®

くろぶし 黒武士

2K



In a Can
GLOSS LIKE MIRROR



**WE CHANGE
THE AEROSOL
AEROSOL CHANGES
THE WORLD**

<http://www.samuraipaint.jp>

Contents

Product Introduction.....	1
---------------------------	---



New Innovation of Aerosol Paint (2K In a Can).....	2
--	---

2K Top Coat Clear.....	3
- Application of 2K SAMURAI®	

2K Epoxy Surfacers.....	4
2K Epoxy Metal Primer	



SAMURAI® Paint Introduction.....	5
----------------------------------	---

Uniqueness of SAMURAI® Paint.....	6
-----------------------------------	---

Common Problems of Aerosol Spray.....	7
---------------------------------------	---

Hydrographics.....	8
--------------------	---

Water Transfer Film.....	9-10
- Activator of Water Transfer Film	

Crystal Effect	11
- Activator of Crystal Effect	

Marble Effect.....	12
- Candy Colours	

Hibiscus Pattern.....	13
- Standard Colours	

"Net" Pattern.....	14
- Metallic Colours	

Attractive Wheel Alloys	
- Fluorescent Colours	

KHAMELEON® (3-Dimension).....	15
2-Coat System	

600°C Heat Resistant Paint (Silicone-based).....	16
Peelable Paint	

Metal Paint Remover.....	17
- Plastic Paint Remover	
Sticker Remover	

SAMURAI® Primer Series.....	18
1K Clear Coat	



GEIGI™ (Motorcycle Cosmetic) Introduction.....	19
--	----

Tire Inflator.....	20
--------------------	----

Motorcycle Shampoo.....	21
-------------------------	----

Tire Shine, Metal Polish & Paint Polish.....	22
--	----



NINJUTSU™ (Motorcycle Maintenance) Introduction.....	23
--	----

Brake Cleaner, Chain Oil & Engine Degreaser.....	24
--	----

Carburettor Cleaner, Spray Grease & Gasket Cleaner.....	25
---	----



PRODUCT INTRODUCTION

We Produce a Complete Range of Motorcycle Products in Aerosol Can for You!

SAMURAI®
くろぶし 黒武士

KHAMELEON®
変色龍
JAPAN FORMULATIONS

AEROSOL PAINT

- Plastic Primer
- Putty Primer
- Paint Remover
- Sticker Remover
- Undercoat
- Colour Coat (Standard Colours, Metallic Colours, Candy Colours, Fluorescent Colours, 2-Coat System & Khameleon 3D paint)
- Top Coat 1K Lacquer

GEIGI™
げいぎ 藝者

MOTORCYCLE COSMETIC

- Motorcycle Shampoo
- Tire Shine
- Metal Polish
- Paint Polish
- Tire Inflator

PEELABLE™

PEELABLE
PAINT

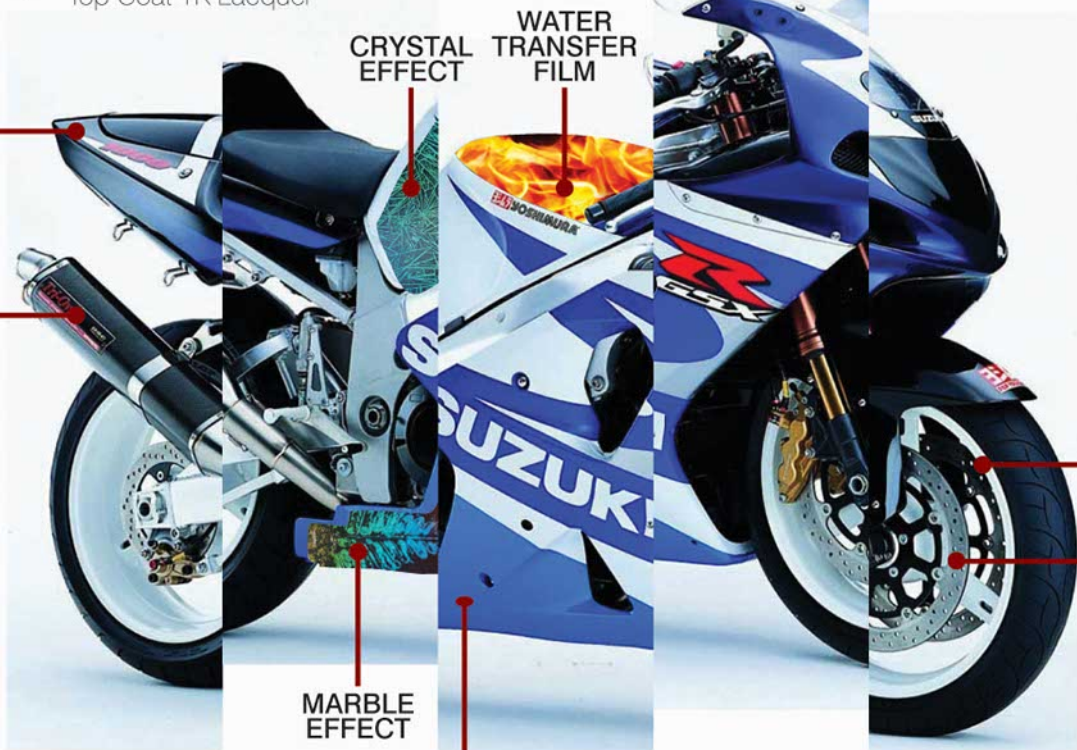

- Hi-Temperature Paint (600°C Heat Resistant)
- Engine Part Paint

2K
In a Can
GLOSS LIKE MIRROR

2K 2-Component

- Top Coat Clear
- Epoxy Surfacer
- Epoxy Metal Primer

NINJUTSU™
にんじゅつ 忍術

MOTORCYCLE MAINTENANCE

- Carburettor Cleaner
- Brake Cleaner
- Gasket Cleaner
- Engine Degreaser
- Spray Grease
- Chain Oil

2K

In a Can
GLOSS LIKE MIRROR

INTELLECTUAL
PATENTED
PROPERTY

NEW INNOVATION OF AEROSOL PAINT

INTELLECTUAL
PATENTED
PROPERTY

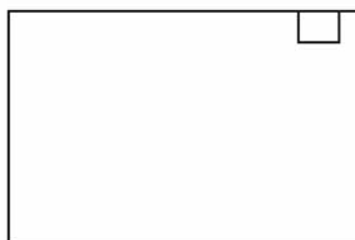
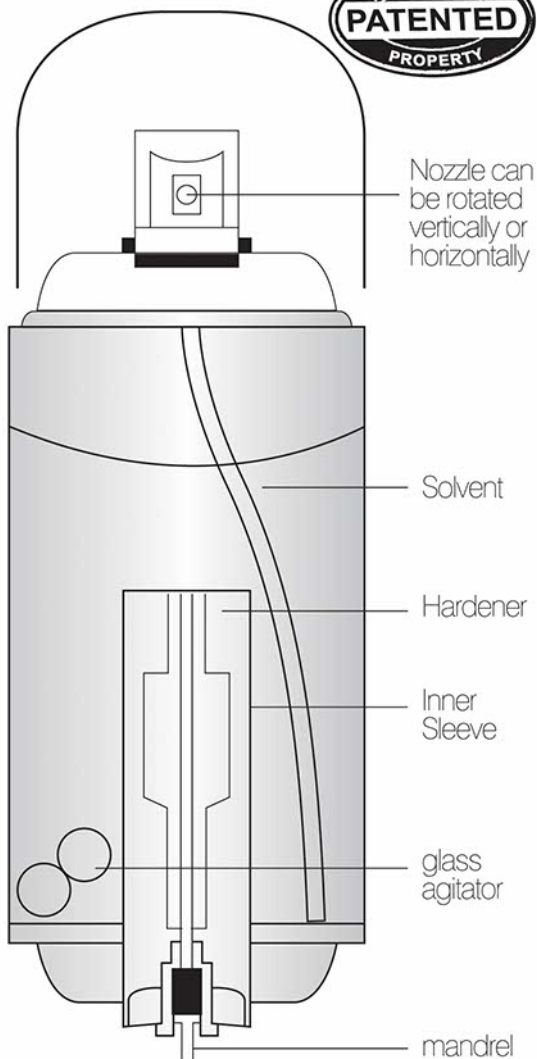

The technology of a traditional aerosol spray can is always unable to break through the limitation of which hardener and resin stored together in a can. When these two chemicals are mixed together, the chemical reaction will cause the mixed paint to solidify over a short period of time and can no longer be used.

However, our SAMURAI® Japanese team had spent over 5 years in the development and research, and have successfully invented a total new innovation of 2K two-component aerosol spray paint! Just a simple step with 2K SAMURAI®, you can enjoy the top quality spray results, just like using a spray gun in a workshop.



THE UNIQUENESS OF 2K 2-COMPONENT SAMURAI®

1. Practise 2 in 1 concept (mix hardener and resin) in an aerosol can.
2. Patented in Utility Innovation & Industrial Design in Malaysia, China, Indonesia, Philippine, Thailand, Vietnam and Australia.
3. Formula ratio of hardener to resin is 1:2 (compared to formula ratio of 1:4 in the market).
4. Guarantee highest product quality results, just like with a spray gun in a workshop.
5. Sprayed items can be dried in temperatures between -7°C to 40°C.
6. VOC (Volatile Organic Compounds) compliant with international convention.
7. Easy to use, no extra equipments needed.



Scan for
2K VIDEO

2K

In a Can
GLOSS LIKE MIRROR

INTELLECTUAL
PATENTED
PROPERTY

SAMURAI®
くろぶし 黒武士

TOP COAT CLEAR

VOLUME :

400ml per can / 405gm

Product Code :

2K01 Clear



THICK & GLOSSY



High gloss clear coat, gives finishes as good as a mirror.



FEATURES:

- Weather resistance.
- Excellent abrasion resistance against scratches.
- Good harness and adhesion.
- Chemical resistance.
- Anti-corrosion

DIFFERENT COATING OF 2K SAMURAI®

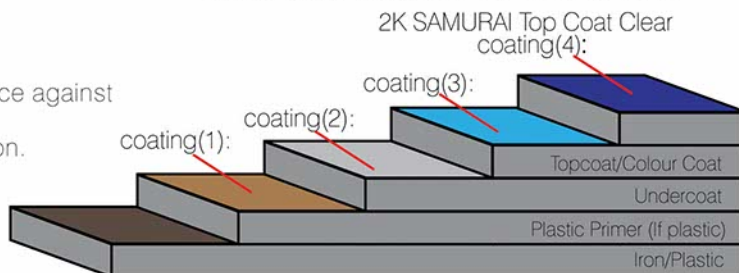

APPLICATION OF 2K SAMURAI®



Application Video

SURFACE PREPARATION

Make sure the surface of the object to be sprayed is clean, degreased and dry.

APPLICATION

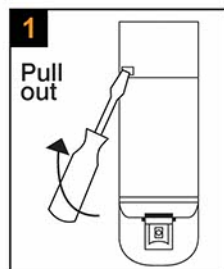

Open the plastic cap.

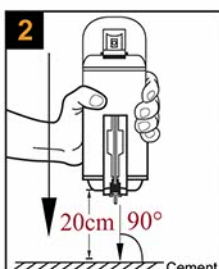

Push the mandrel vigorously.

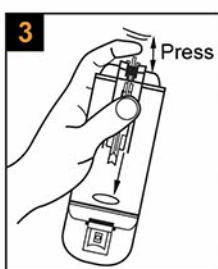

When the mandrel has 'springy' effect, that means the inner sleeve has been broken.

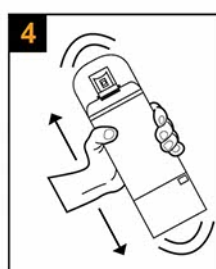

Shake well for 60 seconds.

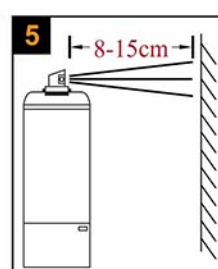

Spray Distance

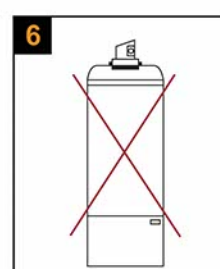

Pot life: 4 hours @25°C.

Unopened can may be stored for 24 months @25°C.

Touch dry : 35 minutes
Completely dry : 7 days
Intercoat : 10-15 minutes

* subjected to spraying and maintenance conditions set by SAMURAI professionals.

EPOXY SURFACER

VOLUME :

400ml per can / 405gm

Product Code :

2K04 Grey



Does your newly sprayed paint 'bite' the paint underneath?



2K SAMURAI® Epoxy Surfer can help you to solve this problem.

It is used to seal filler primers and fairing, to provide a smooth uniform surface before applying top coats.

FEATURES:

- Excellent sanding properties.
- Protected against corrosion and chemical materials.
- Increase the top coat adhesion.
- Safe for use on all conventional paint systems.

Touch dry	: 2 hours
Pot life	: 24 hours

DIFFERENT COATING OF 2K SAMURAI®

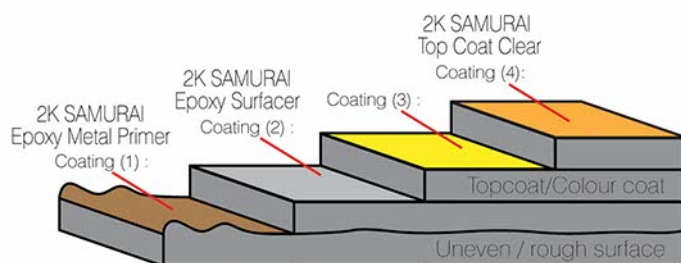

EPOXY METAL PRIMER

VOLUME :

400ml per can / 405gm

Product Code :

2K 05 Red Oxide
2K 06 Silver Grey



It works by penetrating deeply into surface and forms an air and water tight barrier which provides high anti-corrosive protection and long-lasting durability.



FEATURES:

- No lead and chromate.
- Good insulation against humidity.
- Ideal use on new or slightly rusty surfaces to prevent further corrosion.

Touch dry	: 2 hours
Pot life	: 24 hours

I CAN'T IMAGINE THE WORLD WITHOUT SAMURAI® PAINT



SAMURAI® focuses on motorcycle repainting business as well as after market. Its products give the best finishing from custom painting to the original motorcycle colours painting. It is an advance spray paint formulation specially made for DIY fanatics to get the best finishing to the wide range of surfaces. The unique formulae of SAMURAI® are well in line with the advanced technology of Japan, which focus on attaining fulfillment from creativity and innovation.

SAMURAI® provides quick drying, high gloss with excellent colour retention paint. It has good hiding power, which means uses less paint for more coverage. The uniquely modified acrylic formulation provides paint that is softer, more elastic and durable, unlike the traditional type which originally uses the NC (nitro-cellulose) base that cracks and turns yellow easily.

SAMURAI® range also includes products such as plastic primer, putty primer, paint remover, 1K clear coat, 3-Dimension paint (Khameleon), hi-temperature, engine part paint, sticker remover and peelable paint.

THE STRENGTH OF SAMURAI® PAINT

SUPER FLEXIBILITY : THE POWER TO RESIST CRACKING



SAMURAI

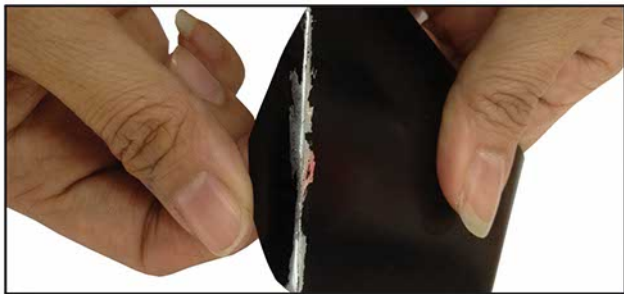

BRAND XYZ

ANTI-PETROL : THE POWER TO RESIST PETROL



SAMURAI



BRAND XYZ

DIFFERENT COATINGS OF SAMURAI® PAINT

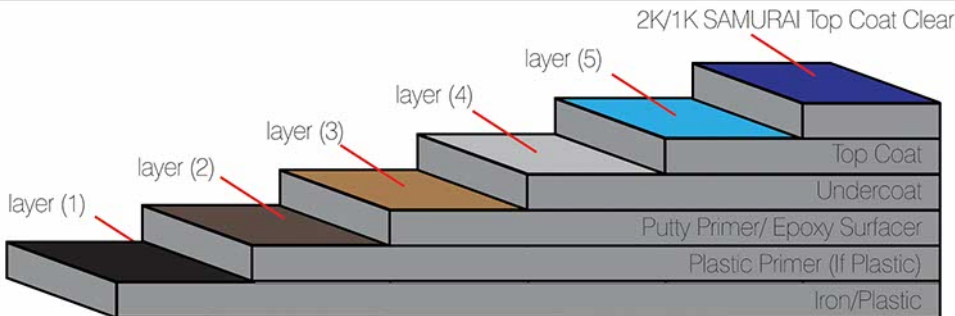

UNIQUENESS OF SAMURAI® PAINT

DIFFERENCE OF VALVES

SAMURAI®



- Inner nozzle is divided to allow paint twisted inside before it is sprayed.
- Only require rough big hand swing to achieve complete and even colour.
- Each spray gives a big round spot to allow easy creation of tone colour.
- Chances of 'tearing' is very low.



USA nozzle

- Unique USA nozzle with air gun like properties.
- Can be turned horizontally or vertically.
- Provide uniform and balanced spray pattern.
- Fine spray pattern and cover all surfaces widely.
- Spray like a professional sprayer.



Rotate vertically

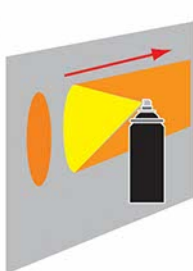

Rotate horizontally

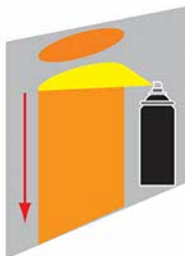

BRAND XYZ



- Still commonly used in certain brands nowadays.
- Its nozzle is narrow and diptube is straight.
- Require rapid hand swing because every spray is fast and straight.
- Hard to achieve tone colour.
- High chance of 'tearing'.

Traditional nozzle



- Unable to turn horizontally or vertically.
- Limitation in spray coverage.
- Need to be skillful to obtain a good spray pattern.

WHY CAN SAMURAI® SAVE MORE PAINT COMPARED TO BRAND "A"?

STRENGTH OF SAMURAI®



- Save paint and not wasted - slow hand motion just like using 'spray gun'.
- Maximum coverage - spray distance must be as near as 5-6" from the surface.
- Easy to achieve tone colour effects.

WEAKNESS OF BRAND A

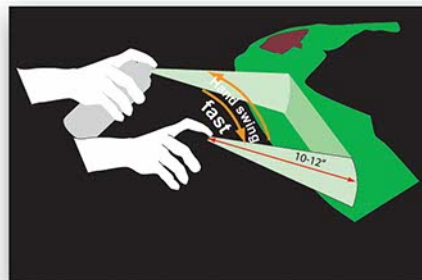

- Must spray from a distance (12") then can get the mist effect.
- Swinging of hand must be fast.
- Hard to achieve tone colour effects.
- 'Tearing' can happen when hand swing becomes slow.